

Tower Fan WDH-TW1803



Dear Customer,

You have chosen a high-quality product. To ensure that you get a lot of enjoyment from this product, here are a few more tips:

In case of any problems:

We hope that the unit meets your expectations! If, despite the greatest possible care, there should ever be cause for complaint, please contact us briefly, as we are very concerned about your satisfaction and would like to clear up any misunderstanding.

Description:

This tower fan is very robustly manufactured and designed for a long service life. The fan has three speed levels. Furthermore, the unit works with a durable high-performance motor.

Important safety instructions:

- This fan is not suitable for use outdoors and/or in wet environments !
- Do not operate the unit in environments where there is a risk of coarse dust, dirt or small objects being sucked in. These could damage the unit or be blown out like projectiles !
- Never walk with your head/face into the near area of the escaping wind stream, small particles or objects can be blown out with it, which can lead to injuries !
- Ensure that the fan stands securely and level and only use it when it is upright and fully assembled !
- Never use the fan on moving surfaces, objects or vehicles ! There is a risk that the unit may tip over !
- Supervise the fan when children are near the unit !
- Never enter or insert objects into the appliance !
- Never try to touch the moving fan motor !
- Do not place any objects on the fan !
- Do not block the supply and/or exhaust air of the unit and please ensure sufficient space/clearance around the unit !
- Ensure that there is sufficient air supply to the unit, otherwise it can lead to a reduction in performance and, in the worst case, to overheating and/or fire !
- Only qualified personnel or electricians are allowed to open the unit !
- Make sure that no moisture gets into the unit !
- Only use the recommended voltage for operating the unit !
- Make sure that the power cable is unfolded (untied) before connecting it to the socket !
- Make sure that the plug is cleanly and properly connected to the socket before using the appliance !
- Never reach near the plug or socket with wet hands !
- Do not repair defective or damaged cables on the unit yourself, you could get a severe electric shock !
- Make sure that highly flammable substances (e.g. gases/oils etc.) are never in the vicinity of the unit !
- If you are not going to use the unit for a long time, switch it off and disconnect the mains plug !
- Never disconnect the mains plug by pulling on the power cable !

Please switch off the unit immediately and disconnect it from the mains/power supply if anything seems to be wrong !!! In this case, please contact a specialist and do not try to repair the unit yourself !!!

Examples: Fan does not run during operation or fuse has blown.

Description of the unit parts:

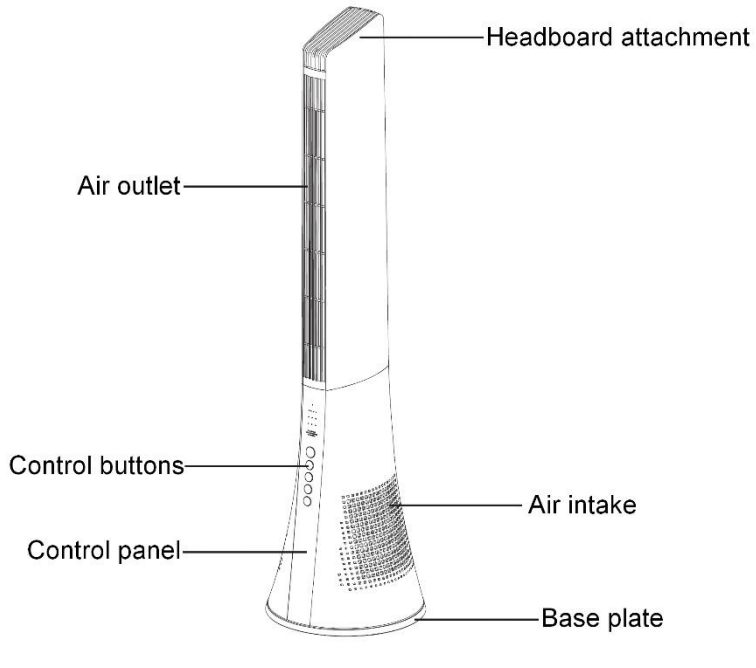

Description of the control panel:

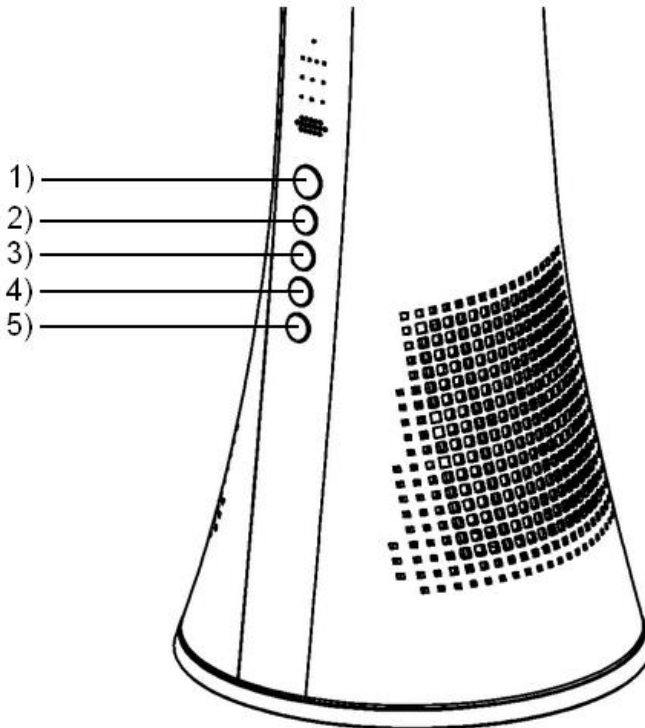

- 1) On/Off button
- 2) Swing button to activate the rotation
- 3) Timer button
- 4) Mode Button for selecting the operating mode
- 5) Speed button for setting the operating strength

Assembly of the appliance parts:

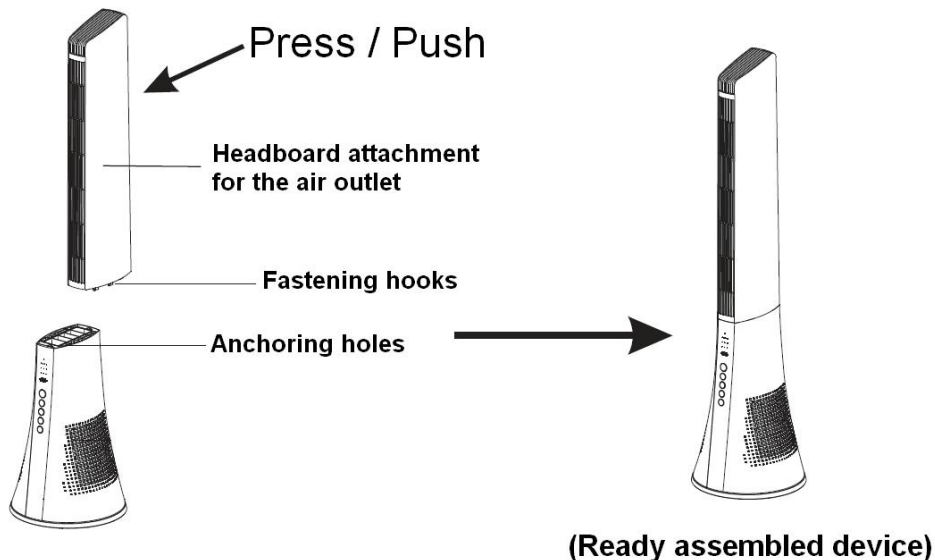

- Take the headboard attachment for the air outlet, on the underside of which there are six fastening hooks.
- Place the fixing hooks in the anchoring holes provided.
- Now push the headboard attachment forward in the direction of the arrow to fix the fastening hooks in the anchoring holes and attach the headboard attachment stably.
- Now the unit should be stable and securely assembled (see right picture).
- Finally, please make sure that the headboard attachment is pushed completely forward to ensure a secure attachment.

Instructions for use:

1. Operational environment

- The maximum operating temperature should not exceed +40°C !
- The maximum relative humidity should not exceed 90% !
- The unit should not be operated at altitudes higher than 1,000 metres above sea level!
- The unit was developed exclusively for indoor use and not for outdoor use !

2. Commissioning

2.1. Position the fan so that the airflow flows in the desired direction after switching on and make sure that the fan is placed on a firm and level surface !

2.2. Now insert the mains plug properly into the socket.

2.3. The fan is switched on by pressing the On/Off button and starts by default in normal operating mode and with low operating power.

2.4. You can set three different operating modes with the Mode button:

- Nor. = Normal operation (at desired operating strength)
- Nat. = Natural operation → is simulated, the fan independently switches back and forth between different operating strengths.
- Sleep = alternating operation The fan → switches sequentially from the highest operating level to the medium and low operating levels. This cycle is repeated.

2.5. Use the speed button to set the desired operating strength / air circulation. (Only possible in normal operating mode) !

You have the choice between three operating strengths:

- Low = Low operating strength / air circulation
- Mid. (Middle) = Average operating strength / air circulation
- Hi. (High) = Highest operating strength / air circulation

2.6. If you want to activate/use the timer function (function for determining the remaining time), press the timer key.

Determining the remaining running time: Press the timer button during operation to select the desired remaining running time of the fan. (A value between 0.5 - 7.5 hours can be selected). After this selected operating time has elapsed, the unit switches off automatically.

2.7. Finally, you can set an independent rotation of the fan by pressing the Swing button.

3. Maintenance, Cleaning & Storage

Please always disconnect the mains plug first and allow the fan to drain completely before carrying out any cleaning activities on your unit !

3.1. Cleaning:

- Use a soft and damp cloth to clean the outside of the unit.
- Only use mild cleaning agents to clean your fan.
- Please make sure that no water gets inside the fan at any time !

3.2. Storage:

- We recommend covering the unit for storage or ideally packing it in its original box.
- Store the unit in a dry and sufficiently ventilated place/space.
- Please disconnect the mains plug if you do not intend to use the unit for a longer period of time.

4. Other operating instructions

- 4.1. Do not disconnect the mains plug by pulling on the power cable !
- 4.2. Do not use insect repellent, oil spray, paint spray, etc. near the fan. This may cause damage to the unit or even fire !
- 4.3. Do not place the appliance on sloping or uneven ground !

Technical data:

Model designation:	WDH-TW1803
Voltage:	230V / 50Hz
Max. Power consumption:	40 W (0.18 A)
Max. Air circulation:	approx. 160 m ³ /h
Protection class:	II
Dimension (H/W/D):	112 x 29 x 28.5 cm
Weight:	4 kg

For the technical data, deviations are reserved !!!

Other:

Warranty statement:

Notwithstanding the statutory warranty claims, the manufacturer grants a warranty in accordance with the laws of your country, but at least 1 year (in Germany 2 years for private individuals). The warranty begins on the date of sale of the appliance to the end user.

The guarantee only covers defects that are due to material or manufacturing faults. Warranty repairs may only be carried out by an authorised customer service. To make a warranty claim, please enclose the original sales receipt (with date of sale).

Excluded from the guarantee are:

- Normal wear
- Improper applications, such as overloading the appliance or non-approved accessories.
- Damage due to external influences, use of force or foreign objects
- Damage caused by non-observance of the operating instructions, e.g. connection to an incorrect mains voltage or non-observance of the assembly instructions.
- Completely or partially dismantled units

Conformity:

The fan has been tested and itself and/or parts thereof have been tested under the following (safety) standards:

Tested by eurofins "GS", and of course with CE conformity and EMC conformity.

Tested safety according to: EN 60335-2-80:2003+A1:2004+A2:2009
EN 60335-1:2012/A13:2017
EN 62233:2008
AfPS GS 2014:01 PAK

CE (LVD) Conformity tested according to: EN 60335-2-80:2003+A1:2004+A2:2009
EN 60335-1:2012/A13:2017
EN 62233:2008

EMC conformity tested according to: EN 55014-1:2017
EN 55014-2:2015
EN 61000-3-2:2014
EN 61000-3-3:2013

Correct disposal of this product:



Within the EU, this symbol indicates that this product should not be disposed of with household waste. Waste equipment contains valuable recyclable materials that should be recycled and not harm the environment or human health through uncontrolled waste disposal. Therefore, please dispose of old appliances via suitable collection systems or send the appliance for disposal to the place where you purchased it. They will then recycle the appliance.

We hope you enjoy using this appliance:

Your Aktobis AG

Keep these instructions for use in a safe place !

